

Binks MODEL 69 & 69V SPRAY GUNS OPERATION & MAINTENANCE INSTRUCTIONS

CONTROLLING THE FAN SPRAY: The fan spray for an external mix nozzle set-up is easily controlled by means of the Side Port Control 54-1024. Turning this control to the right, or clockwise, until it is closed will give a round spray; turning it to the left, or counter-clockwise, will widen the spray into a fan shape of any width desired. The direction of the fan spray, either horizontal or vertical, is obtained by turning the air nozzle to the desired position, then tightening the retainer ring.

CONTROLLING THE FLUID: If a fluid pressure tank is used, the amount of fluid can be controlled by regulating the pressure on the tank. The amount of fluid can also be controlled by means of the Fluid Control 54-1007. Turning this screw to the right, or clockwise, reduces the amount of fluid; to the left, or counter-clockwise, increases the amount of fluid.

FAULTY SPRAY: A faulty spray is caused by improper cleaning or dried material around the fluid nozzle tip or in the air nozzle. Soak these parts in a solvent that will soften the dried material and remove with a brush or cloth. Never use metal instruments to clean the air or fluid nozzles. These parts are carefully machined and any damage to them will cause a faulty spray. If either the air nozzle or fluid nozzle is damaged, the part must be replaced before a perfect spray can be obtained.

TO REPLACE THE FLUID PACKING: Remove the Fluid Control Screw 54-1007, Spring 54-1347 and needle. Then remove the Fluid Packing Nut 56-164 and take out the old packings with a small stiff wire. Replace with new Packings 54-764 oiled lightly and assemble in reverse order. To set packing, insert needle, tighten nut until the needle begins to be too stiff for the spring to move needle. Then loosen nut 1/2 to 3/4 turn.

CORRECTING AIR LEAK THROUGH GUN: Air leaking through the gun is caused by the Valve Stem

Assembly 54-1025, not seating properly against the Valve Body 54-1010. Remove the Valve Body 54-1010 and Valve Stem Assembly 54-1025. Thoroughly clean parts and inspect for damage. Replace worn or damaged parts and assemble in reverse order.

CORRECTING AIR LEAK AROUND AIR VALVE STEM: Air leaking around the Air Valve Stem 54-1025 may be caused by worn Packings 82-158 or damaged Air Valve Stem 54-1025. Remove Trigger 54-1050, Packing Nut 82-135 and Packings 82-158. Clean extended portion of Air Valve Stem 54-1025 and inspect for damage; if stem is damaged, replace same as above, insert new packings and assemble in reverse order.

TO ADJUST FLUID NEEDLE WHEN WORN: To adjust the fluid needle remove Control Screw 54-1007, Spring 54-1347 and Needle. With two 1/4" wrenches loosen the Lock Nuts 54-2550 and 54-2549 back off Lock Nut 54-2550 one full turn and bring up Lock Nut 54-2549 and tighten snugly. Reassemble in reverse order.

CLEANING THE GUN -

WHEN USED WITH PRESSURE TANK: Shut off the air supply to the Pressure Tank and release the pressure in the tank. Hold a piece of cloth over the gun nozzle and pull the trigger, the air will back up through the fluid nozzle and force the fluid out of the hose and into the tank. Remove paint from tank, clean tank and put enough compatible solvent into the tank to clean the hose and gun thoroughly. Spray this through the gun until it is clean, then blow out the fluid hose to dry it and remove all traces of materials by attaching it to the air line.

WHEN USED WITH A CUP: A compatible solvent should be siphoned through gun by inserting tube from siphon cup in an open container of solvent. Trigger gun intermittently to thoroughly flush passageways and internal parts.

*NOZZLE TIP:

200 SERIES, NITRALLOY

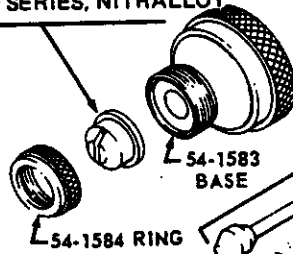

INTERNAL MIX HEAVY MATERIAL

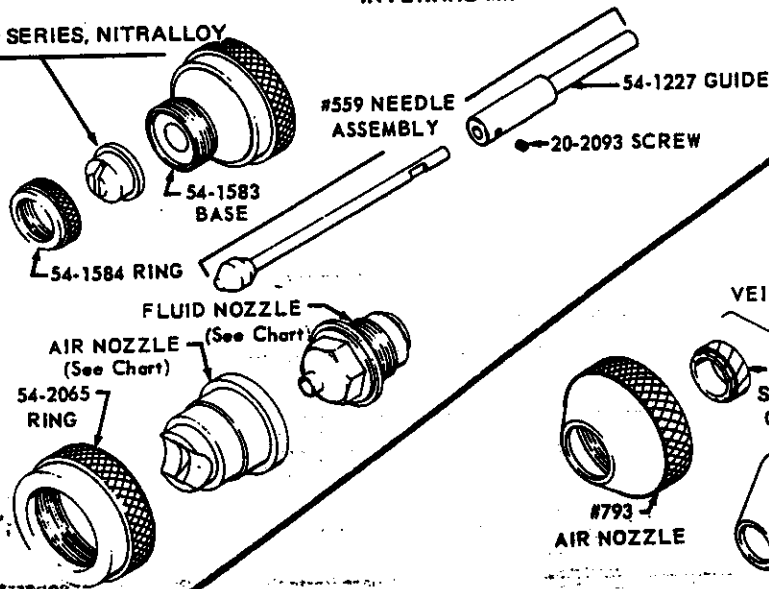

SPECIAL NOZZLES

SPECIAL EFFECT NOZZLES

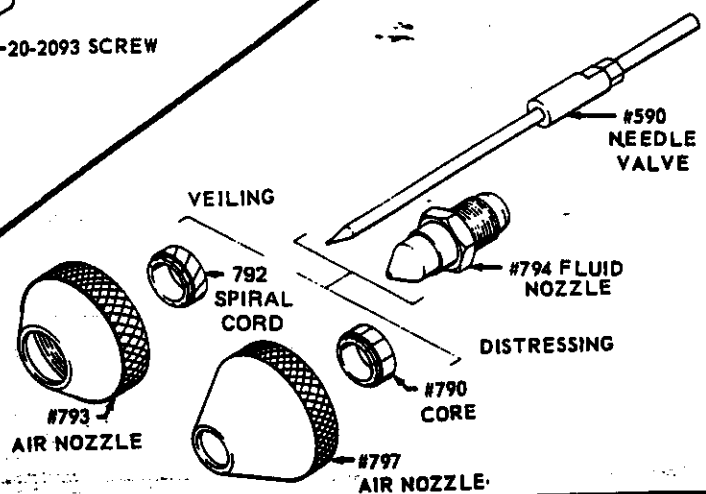

BINKS

MANUFACTURING COMPANY

9201 West Belmont Avenue, Franklin Park, Illinois 60131

Replaces
Part Sheet
1878R-3

Part Sheet
1878R-4

Binks MODEL 69 & 69V SPRAY GUNS

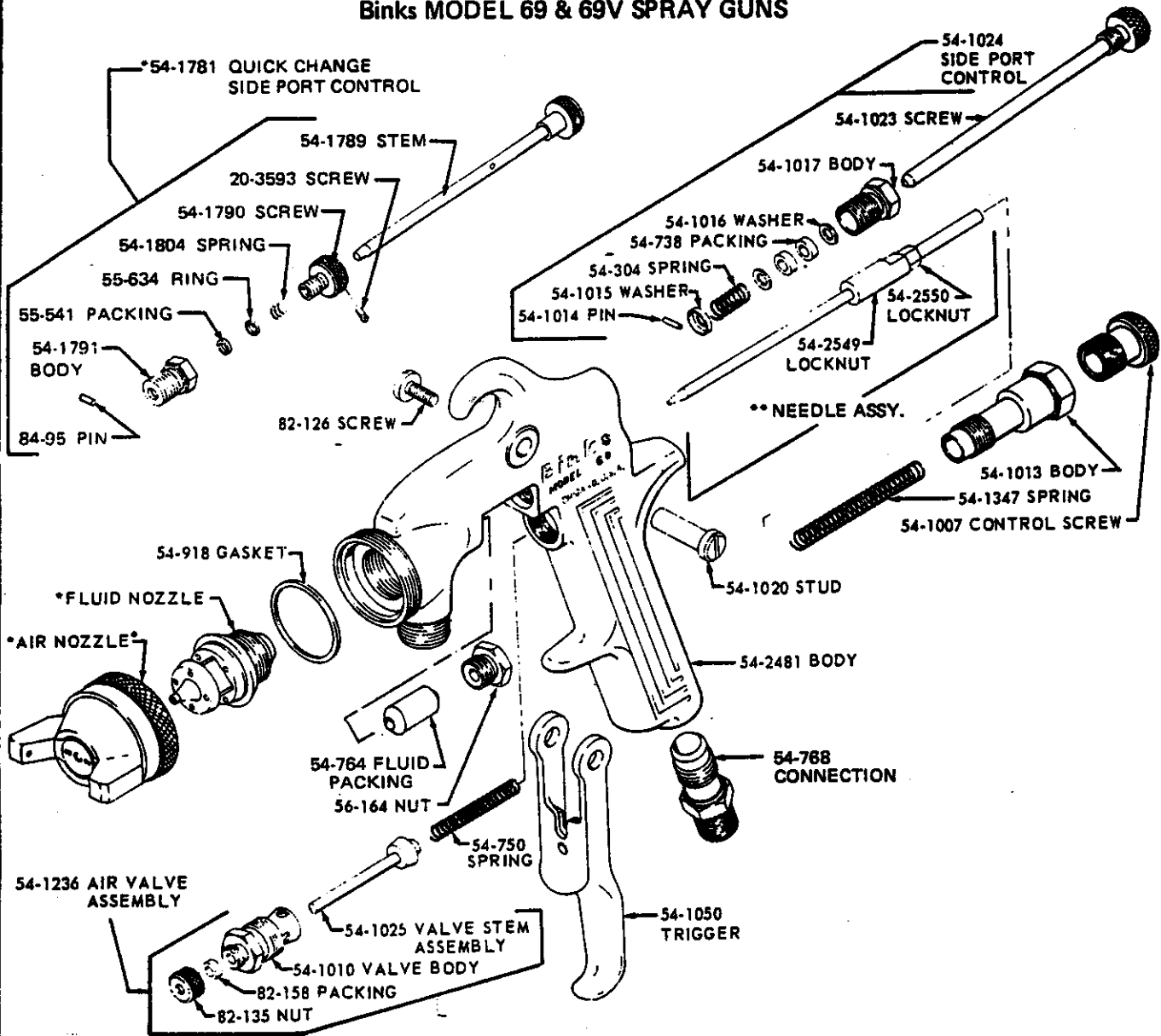

PARTS LIST

PART NO.	DESCRIPTION	QTY.	PART NO.	DESCRIPTION	QTY.
*	AIR NOZZLE.....	1	54-1020*	STUD.....	1
*	FLUID NOZZLE.....	1	54-1023	SCREW.....	1
*	NEEDLE VALVE ASSEMBLY.....	1	54-1024	SIDE PORT CONTROL.....	1
54-304*	SPRING.....	1	54-1025*	VALVE STEM ASSEMBLY.....	1
54-738†	PACKING.....	2	54-1050	TRIGGER.....	1
54-764†	FLUID PACKING.....	1	54-1236	AIR VALVE ASSEMBLY.....	1
54-750*	SPRING.....	1	54-768	CONNECTION.....	1
54-918†	GASKET.....	1	54-1347*	SPRING.....	1
54-1007	CONTROL SCREW.....	1	54-1781*	QUICK CHANGE SIDE PORT CONTROL.....	1
54-1010	VALVE BODY.....	1	54-2481	BODY.....	1
54-1013	BODY.....	1	54-2549	LOCK NUT.....	1
54-1014*	PIN.....	1	54-2550	LOCK NUT.....	1
54-1016	WASHER.....	1	56-164	NUT.....	1
54-1016	WASHER.....	2	82-126*	SCREW.....	1
54-1017	BODY.....	1	82-135	NUT.....	1
			82-158†	PACKING.....	1

* When ordering, please specify number stamped on nozzle.

† When ordering, please specify gun model and number stamped on needle stem.

• Also available in Repair Kit 6-195. Please order separately.

† Also available in Spare Parts Kit 6-185. Please order separately.

• Not furnished. Please order separately.

Accessories: 41-119 Plug may replace the 54-1024 Assembly when using internal mix nozzles.

TYPE OF FLUID TO BE SPRAYED	FLUID NOZZLE	AIR NOZZLE	TYPE *	CFM AT			MAX. PAT. AT 8"	FLUID NEEDLE NO.
				30 PSI	50 PSI	70 PSI		
HEAVY (CREAM-LIKE)								
Over 28 SECS. - NO. 4 FORD								
HOUSE PAINT	66	204	PI	3.9	5.5	7.4	9.0"	565
WALL PAINT (OIL, LATEX)	67	206	PI	6.0	9.5	13.0	15.0"	567
BLOCK SEALERS	68	201	PI	4.6	6.8	9.1	11.0"	568
MILL WHITES	66	63PB	PE	9.0	14.3	20.0	14.0"	565
VINYLS	67	67PB	PE	9.5	14.9	19.5	12.0"	567
ACRYLICS	68	68PB	PE	9.5	14.1	19.1	12.0"	568
EPOXIES								
VERY HEAVY								
UNAGGREGATED	68	206	PI	6.2	9.8	13.2	15.0"	568
BLOCK FILLERS	68	68PB	PE	9.5	14.1	19.1	12.0"	568
TEXTURED COATINGS	59A	241	PI	4.1	6.0	8.2	12.0"	559
FIRE RETARDANTS	59A	242	PI	4.1	6.0	8.2	6.0"	559
ROAD MARKING PAINT	59A	243	PI	6.4	10.0	13.4	Rd.	559
BITUMASTICS	59A	244	PI	7.8	11.5	15.2	12.0"	559
CELLULAR PLASTISOLS	59A	245	PI	7.8	11.5	15.2	6.0"	559
UNDERBODY	59B	250	PI	7.3	11.0	14.7	Rd.	559
ROOF COATINGS	59B	251	PI	7.8	11.5	15.2	12.0"	559
	59B	252	PI	7.8	11.5	15.2	6.0"	559
	59C	260	PI	7.8	11.5	15.2	Rd.	559
	59C	261	PI	8.0	12.0	15.9	12.0"	559
	59C	262	PI	7.3	11.0	14.7	6.0"	559
ADHESIVES								
WATERBASE WHITE	63CSS	63PB	PE	9.0	14.3	20.0	14.0"	563A
VINYL GLUE	66SS	63PR	PE	9.5	15.5	19.5	15.0"	565
SOLVENT BASE	67SS	67PB	PE	9.5	14.1	19.1	12.0"	567
NEOPRENES	63	66SD	PE	7.9	12.1	16.2	4.0"	563
(CONTACT CEMENTS)	63A	66SD	PE	7.9	12.1	16.2	7.0"	563A
	63B	66PJ	PE	9.5	14.2	19.0	10.0"	563A
CERAMICS & SIMILAR ABRASIVE MATERIALS								
GLAZES, ENGOBES	63CVT	66PH	PE	11.5	16.4	22.0	13.0"	563CVT
PORCELAIN ENAMEL	64VT	64PA	PE	12.1	15.0	21.0	13.0"	564VT
	67VT	67PD	PE	10.0	15.0	20.0	15.0"	567VT
	68VT	68PB	PE	9.5	14.1	19.1	12.0"	568VT
CONCRETE CURING COMPOUNDS								
	66	200	PI	3.1	5.2	6.4	15.0"	565
	67	206	PI	6.0	9.5	13.0	18.0"	567
	68	206	PI	6.2	9.8	13.2	20.0"	568
MULTICOLOR PAINTS								
	66	200	PI	3.1	5.2		12.0"	565
	67	206	PI	6.0	9.5		15.0"	567
	67	67PD	PE	10.0	15.0	20	13.0"	567
TEFLONS								
	63ASS	63PB	PE	9.0	14.3	20.0	10.0"	563A
	63BSS	63PR	PE	9.5	15.5	19.5	15.0"	563A
	66SS	66SD	SE	7.9	12.1		7.0"	565
HAMMERS								
	63C	63PB	PE	9.0	14.3		14.0"	563A
	66	63PB	PE	9.0	14.3		14.0"	565
	66	66SD	SE	7.9	12.1		7.0"	565
WRINKLE ENAMELS								
	63C	63PB	PE	9.0	14.3	20.0	10.0"	563A
	66	63PB	PE	9.0	14.3	20.0	10.0"	565
SPECIAL EFFECT FINISHES								
VEILING	794	793	PE	3 AT 15 PSI				590
DISTRESS FINISH	794	797	PE	3 AT 15 PSI				590
SPATTER FINISH	66	66PD	PE	3 AT 15 PSI				565

FLUID NOZZLE ORIFICE SIZES

59A	59B	59C	63	63A	63B	63C	63CVT	64VT	65	66	67	67A	67VT	68	68VT	794
.171	.281	.281	.028	.040	.046	.052	.064	.064	.059	.070	.086	.086	.086	.110	.110	.040

All air nozzles shown in combination with these (+) fluid nozzles can also be used in combination with any other fluid nozzle marked (+).

